

CHUCK ADAPTORS

Chuck Adaptor Plates
ASA B5.9 type A
(Interchangeable DIN 55026)

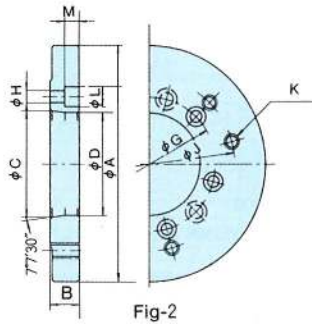
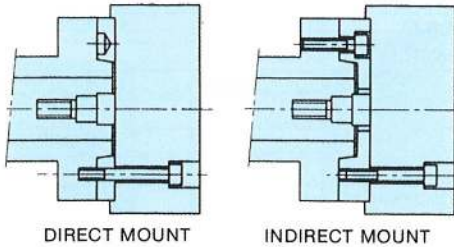

Fig-2

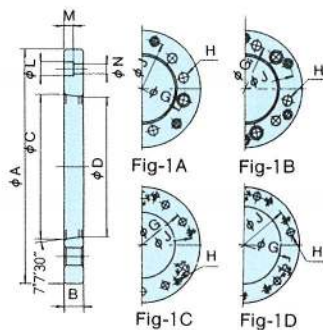
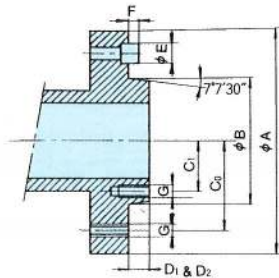

Fig-1A

Fig-1B

Fig-1C

Fig-1D

SPINDLES

Model	Nose	5	6	8	11	15
N	6	CB-06A05				
	8	CN-08A05	CB-08A06			
	10		CN-10A06	CB-10A08		
	12		CN-10A06	CB-10A08		
NLT	6	CBT06A05				
	8	CNT08A05	CBT08A06			
	10		CBT10A06	CBT10A08		
	12		CBT10A06	CBT10A08		
B	6	CB-06A05				
	8	CB-08A05	CB-08A06			
	10		CB-10A06	CB-10A08		
	12		CB-10A06	CB-10A08		
	15			CB-15A08	CB-15A11	
	18			CB-18A08	CB-18A11	
	21				CB-21A11	CB-21A15
	24				CB-21A11	CB-21A15
BT	6	CBT06A06				
	8	CBT08A05	CBT08A06			
	10		CBT10A06	CB-10A08		
	12		CBT10A06	CB-10A08		
	15			CB-15A08	CBT15A11	
B-200, BL-200	6	CB-06A05				
	8	CB-08A05	CB-08A06			
	10		CB-10A06	CB-10A08		
	12		CB-10A06	CB-10A08		
BT200	6	CBT06A05				
	8	CBT08A05	CBT08A06			
	10		CBT10A06	CB-10A08		
	12		CBT10A06	CB-10A08		

DIMENSIONS

For ASA B5.9 type A (Interchangeable DIN 55026)

Type	CB 06A05	CB 08A05	CB 08A06	CB 10A06	CB 10A08	CB 15A08	CB 15A11	CB 18A08	CB 18A11	CB 21A11	CB 21A15	CB 10A06
Spindle Nose	A2-5	A2-5	A2-6	A2-6	A2-8	A2-8	A2-11	A2-8	A2-11	A2-11	A2-15	A2-6
A	140	170	170	220	220	300	300	380	380	380	380	200
B	15	22	17	25	18	33	22	33	22	41	27	20
C	82.557	82.557	106.377	106.377	139.722	139.722	196.870	139.722	196.870	196.870	285.750	106.377
D	79.7	79.7	103	103	136	140	192.1	140	192.1	192.1	252	103
E	16.28	16.28	19.46	19.46	24.21	24.21	29.36	24.21	29.36	29.36	35.71	19.46
F	6.5	6.5	6.5	6.5	8	8	10	8	10	10	10	6.5
G	104.78	104.78	133.35	133.35	171.45	171.45	235	171.45	235	235	330.2	133.35
H	12	11	13.5	13.5	17	17	21	17	21	21	24	13.5
J	116	133.35	150	171.45	190	235	260	235	320	330.2	330.2	171.45
K	-	M12	-	M16	-	M20	-	M20	-	M22	-	M16
L	11	17	11	20	14	25	17	25	17	32	20	20
M	7	11	7	13.5	10	17	11	17	11	21	15	8
N	6.6	-	6.6	-	9	-	11	-	11	-	13.5	-
Fig	1A	2	1B	2	1C	2	1C	2	1C	2	1D	2

SHORT TAPER SPINDLE NOSE STANDARDS

Type A1 and A2 ASA B5.9 type A, DIN 55026, ISO B702 Part 1, BS 4442 Part 1

SPINDLE NOSE SIZE NO.		A2-5	A2-6	A2-8	A2-11	A2-15
NA Outside Diameter	A	133	165	210	280	380
Max. Taper Diameter	B	82.563	106.375	139.719	196.869	285.775
P. C. R. Outer Bolts	CO	52.4	66.7	85.7	117.5	165.1
P. C. R. Inner Bolts(A1 only)	C1	30.95	41.30	55.55	82.55	123.8
Spigot Height(A1 only)	D1	14.29	15.88	17.46	19.05	20.64
Spigot Height(A2 only)	D2	13	14	16	18	19
Driving Stud Diameter	E	15.90	19.05	23.80	28.60	34.90
Driving Stud Height	F	5	5	6	8	8
Bolt Hole Size	G	M10	M12	M16	M18	M22