

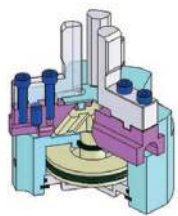

Known for superior performing lathe chucks, Kitagawa brings its world-renowned engineering and manufacturing expertise to the world of automation. Presenting the **NEW Promano Grippers**, ideal for countless automation operations and the only grippers in the market to provide **Made in the USA** custom engineered fingers for the most critical gripping needs.



KTS3: 3 Jaw Parallel Gripper

- ▶ Multiple variations and finger options available
- ▶ Light weight and compact body
- ▶ High repeatability and long operating life
- ▶ Standard model is suitable for various automation operations

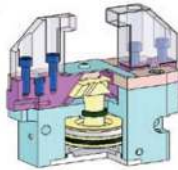

KPG2: 2 Jaw Parallel Gripper with Split Body

- ▶ Split body enables easy cleaning and parts replacement
- ▶ Multiple variations and finger options available
- ▶ Light weight and compact body
- ▶ High repeatability and long operating life

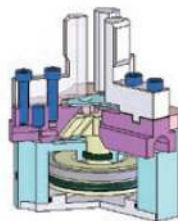

KPG3: 3 Jaw Parallel Gripper with Split Body

- ▶ Split body enables easy cleaning and parts replacement
- ▶ Multiple variations and finger options available
- ▶ Light weight and compact body
- ▶ High repeatability and long operating life

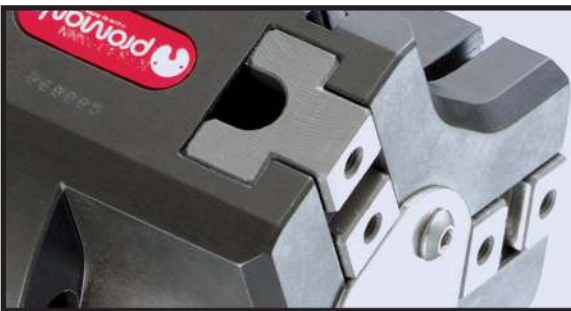

KPGT2: 2 Jaw Parallel Gripper - Low Profile

- ▶ Low profile body and high gripping force
- ▶ Multiple variations and finger options available
- ▶ High repeatability and long operating life

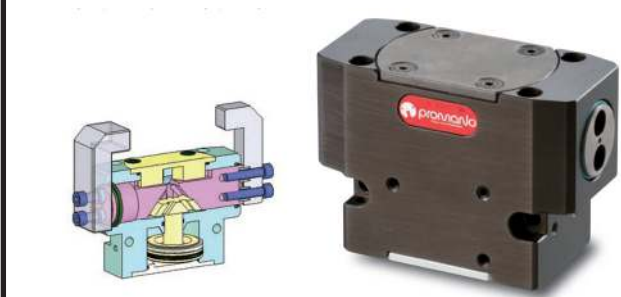

KPH-2: 2 Jaw Parallel Gripper - Sealed Body

- ▶ Light weight and compact body
- ▶ High repeatability and long operating life
- ▶ Waterproof and dustproof design to endure the most severe conditions



KPGB3: 3 Jaw Parallel gripper w/ Through Hole

- ▶ Large through hole
- ▶ Light weight and compact body
- ▶ High repeatability and long operating life



Productivity Team: Dedicated to solving complex machining challenges through consultation and custom designed solutions.



Repair, Rebuild & Installation Services: Complete in-house and on-site repair services for all workholding brands.



Manufacturing Services: Comprehensive manufacturing capabilities to streamline product availability and delivery.



Extensive Clamping and Gripping Solutions: Chucks, cylinders, rotary tables, custom workholding, collet chucks, steady rests, clamping/fixturing, automation grippers, vises and complete workholding accessories.